

THC3 Series Hybrid Tantalum Capacitor

Brief Introduction

- Tantalum case encapsulation, Hermetically Sealed,Cylindrical,Axial-lead,Heteropolarity;
- Commingled by Electrolytic Tantalum Capacitor and Electrochemical Capacitor,Small in size,Super Capacitance;This series products is firstly witnessed at home;
- Stable in Electrical Performances,High Reliability,Long life-span, Maximum in the Density of Capacitance and Energy,Nominal Capacitance is wider than THC2;
- Operative Standard: GJB733A-96、 QJ/PWV311-2009
- Ordering Information: THC3-25V70000μF -M, 100 purchase



Features

- Operating Temperature Range:-55°C~+125°C (>85°C with rated voltage derating)
- Storage Temperature Range:-62°C~+130°C
- Capacitance tolerance: Q: -10%~+30%;K: ±10%; M: ±20%
- Electrical Performances:See tables

Table1 Electrical Characteristics

Dimensions and Fixing Frame See Figure

Rated Voltage (V)	Category Voltage (V)	Ripple Current (V)	Nominal Capacitance (μF)	Tgδ (%)	ESR (Ω) 1KHz	DCL (μA)		Impedance (Ω) 100Hz	Range of capacitance (%)		D×H (mm)	Max Weight (g)
						25°C	85°C,125°C		-55°C	-55°C		
10	6	11	200000	190	0.025	400	1800	1	-80	160	36×20	145
			230000								36×24	165
16	9.5	17.6	120000	170	0.025	400	1800	1	-80	160	36×20	145
			140000								36×24	165
25	15	27.5	70000	140	0.025	400	1800	1	-75	160	36×20	145
			86000								36×24	165
35	21	38.5	50000	100	0.025	400	1800	1	-70	160	36×20	145
			60000								36×24	165
50	30	55	30000	75	0.025	400	1600	1.2	-60	160	36×20	145
			32000								36×20	145
			33000								36×24	165
63	38	70	16000	55	0.035	400	1600	1.4	-50	100	36×20	145
			18000								36×24	165
80	48	88	11000	45	0.035	500	2500	1.6	-40	100	36×20	145
			13000								36×24	165
100	60	110	4800	40	0.035	500	2500	1.8	-30	80	36×20	145
			6000								36×24	165
125	75	138	2200	35	0.050	500	2500	2.4	-25	50	36×20	145
			2800								36×24	165

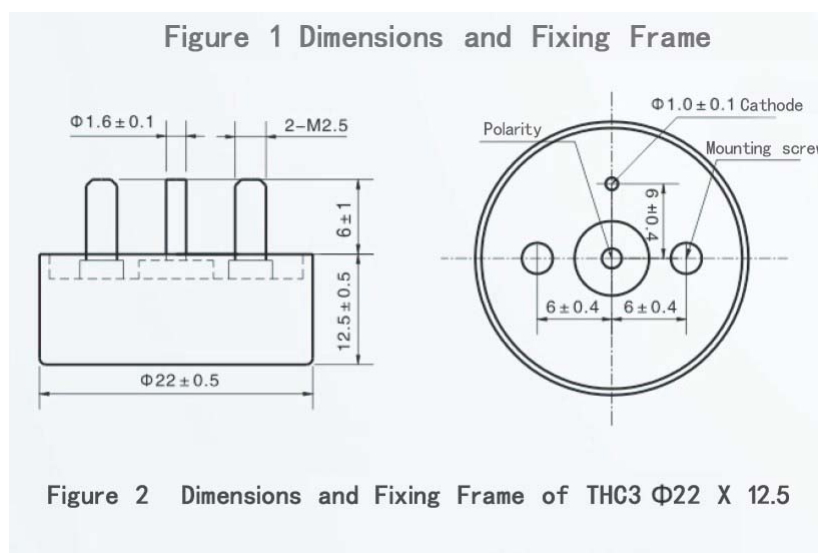
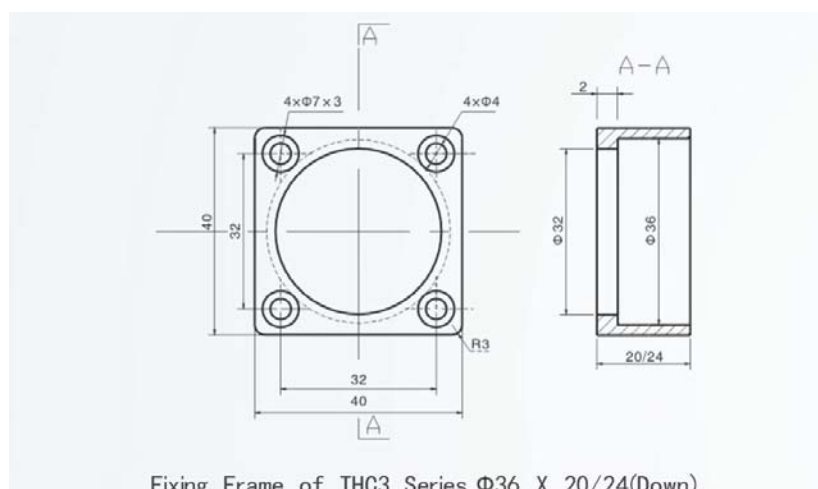
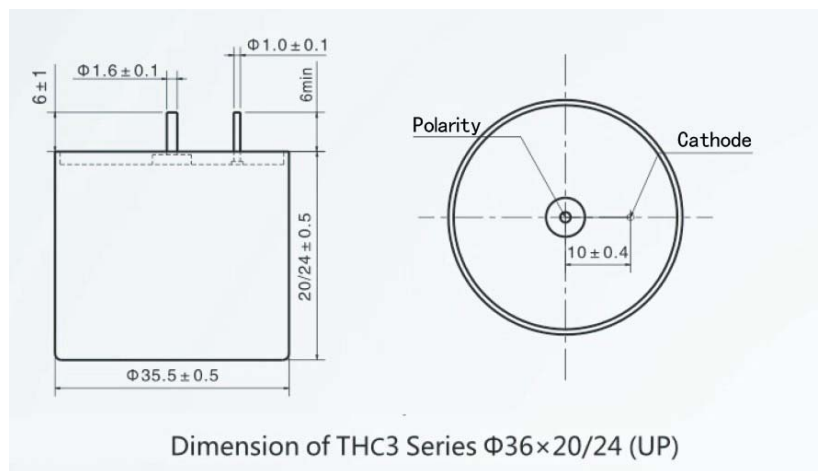

P.S. : 1 Please do not use multimeter through the measuring procedures.

2 Capacitance and DF measured at :100Hz, $U_{DC} = 2.2^{+0.1}V$, $U_{AC} = 1.0^{+0.05}V$, Frequency=100Hz.

Test only applied in series equivalent circuit.

3 Voltage derating is applied at +125°C. (The DCL parameter should be read after 5 minutes when it connected to the circuit).

4 Special size and demand could consult with us.